

SHLAA Proforma

Site location

Site name	Walpole Park Car Park Lower Level (sub section 5,6,7)	Site reference	WTSPD29
Site address and post code	South Street, Gosport, PO12 1NH	Ward	Town Centre
Last updated	December 2018		

Site details

Site description	A large area of long stay public car parking located between the residential development to the south of South Street and Walpole Park. The site serves the Town Centre as well as users of the ferry.
Topography	Flat with asphalt hardstanding
Existing land use	Car park
Surrounding land use and storey heights	To the north, the site is adjacent residential properties which front onto Church Path as well as the top section of the Walpole Park Car Park. The site is separated from these areas by a short steep slope marking previous fortifications. To the east are residential properties fronting Trinity Close off Haslar Road. To the south and west the site is bordered by Walpole Park and the boating lake.
Site size	0.67 ha
Development status	None

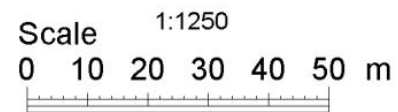
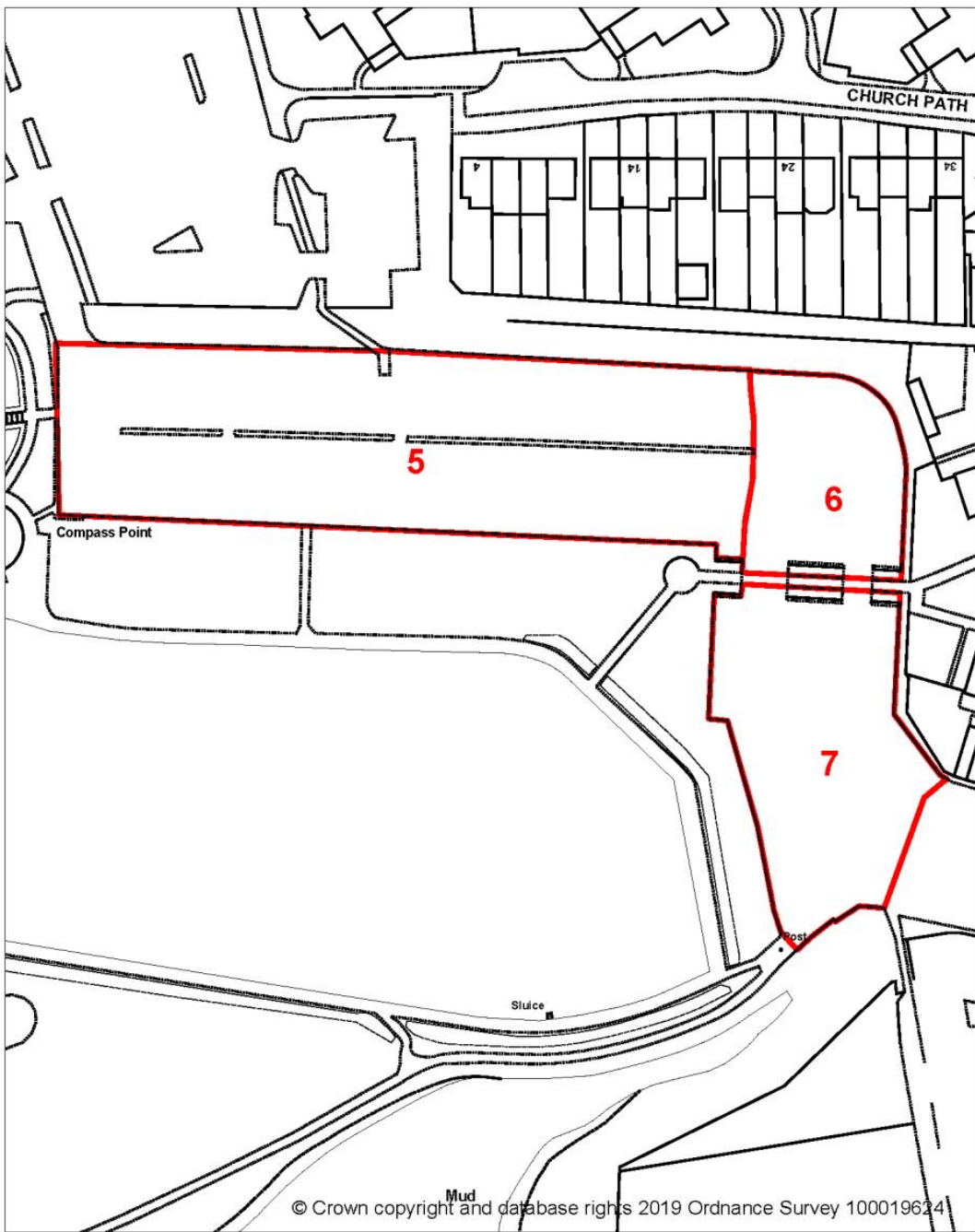

If this map has been transmitted electronically, use the scale bar in preference to the written scale

Key

	Unconstrained
	Site may be acceptable, subject to further study, infrastructure or mitigation works, or policy requirements
	Site is not suitable for allocation

Suitability

Issue	Suitability	Comments	Actions
Local plan designations			
Is the site within the Urban Area Boundary?	Yes		
Is the site allocated for development?	No	Site may still be appropriate for development.	
Is the site in the Strategic Gap?	No		
Is the site Protected Open Space?	No		
Is the site a Protected Employment Site?	No		
Does the site have a community, culture or leisure use?	No		
Is the site within a Defined Shopping Area?	No		

Issue	Suitability	Comments	Actions
Is the site currently tourist accommodation?	No		
Flooding			
Is the site in Flood Zone 2 or 3?	Yes	Site is in flood zone 3 with parts in zone 2. Strategic Flood Risk Assessment is required.	
Is the site predicted to be in Flood Zone 2 or 3 in 2115?	Yes	Site predicted to be in flood zone 2 and 3 by 2115. Strategic Flood Risk Assessment is required.	
Ecology			
Does the site contain any irreplaceable habitats (such as ancient woodland or ancient and veteran trees)?	No		
Does the site have any TPO trees?	No		
Does the site contain any protected species (bats, badgers, Great crested newts)?	No		
Does the site contain, or is within 400m of, a SAC or possible SAC, SPA or potential SPA, Ramsar site or proposed Ramsar site, a Brent	Yes	Adjacent Cockle Pond and Haslar Lake (Portsmouth Harbour) The Solent and	

Issue	Suitability	Comments	Actions
Goose site or proposed Brent Goose site, or a biodiversity-offset site?		Dorset Coast potential SPA (50m). An ecology survey may be required. Development will not be permitted unless no adverse impact upon the habitat can be demonstrated.	
Does the site contain, or is in proximity of, a SSSI or candidate SSSI?	Yes	Adjacent Cockle Pond and Haslar Lake (Portsmouth Harbour). An ecology survey may be required. Development will not be permitted unless no adverse impact upon the habitat can be demonstrated.	
Does the site contain, or is in proximity of, a SINC, candidate SINC or a Local Green Space?	Yes	Rampart Moat (80m); Arden Park (320m). Proposals should protect the habitat.	
Access			
Can satisfactory vehicular access be achieved?	Yes		
Can safe pedestrian and cycle access be achieved?	Yes		

Issue	Suitability	Comments	Actions
Can adequate emergency service and refuse truck access be provided?	Yes		
Heritage			
Is the site within or is adjacent to a Conservation Area?	Yes	Within 100m of the High Street Conservation Area. a Heritage Statement will be required. Proposals will need to preserve or enhance the character of the conservation area.	
Does the site contain, or is adjacent to, any Designated Heritage Assets (listed buildings, scheduled ancient monuments or registered parks and gardens)?	Yes	Trinity Church is 115m away. A Heritage Statement will be required. Proposals will need to preserve or enhance the heritage assets.	
Does the site contain, or is adjacent to, any locally listed buildings?	No		
Is the site likely to be of archaeological interest?	Yes	Historic building pattern underneath the existing structure, including the remains of the Gosport lines. An archaeological assessment will be required.	

Issue	Suitability	Comments	Actions
Contamination			
Is it likely the site could be contaminated?	Yes	Reclaimed land potential contamination and stability issues. A Contaminated Land Assessment and potential mitigation will be required.	
Amenity			
Is development likely to have an adverse impact upon neighbouring amenity?	Yes	Residential amenity of adjoining properties. Proposal will need to minimise amenity impacts.	
Are neighbouring uses likely to have an adverse impact upon the amenity of future occupiers (industrial uses, major roads)?	No		
Services			
Is the site likely to be serviced by utilities?	Yes	Sewerage capacity unknown.	
Is the site within a Safeguarded Area (other than Southampton Airport Safeguarding Zone, which covers the whole borough)?	No		

Availability

Issue	Availability	Comments	Actions
Does the site have multiple owners?	No	Site is owned by GBC.	
Is the site owned by a developer or is the owner willing to sell?	No		
Is it necessary to acquire land off-site to develop this site?	No		
Does the site have any legal issues (covenants, ransom strips)?	No		
Are there any on-site constraints (pylons, rights of way, easements)?	No		
Are there any existing tenancies or operations on site?	Yes	Site is used for car parking. Confirmation will be required that site is no longer needed. Subject to further work on Car Parking Strategy.	

Achievable

Issue	Achievability	Comments	Actions
Is there a realistic prospect that the site would come forward for development within the plan period?	No		
Are there any known abnormal development costs (contamination, heritage conservation, demolition etc)?	Yes	Potential decontamination and site clearance costs. Funding or planning gain may be needed to make the site viable.	
Does the site require significant new infrastructure investment in order to be suitable for development?	No		

Conclusion

Suitable	Available	Achievable
-----------------	------------------	-------------------

Issue	Figure	Assumptions
Developable area	0.67 ha	Based on whole site
Local area density	High	150 dph
Capacity for dwellings	100	Based on density calculation

Concluding comments	<p>The Gosport waterfront and Town Centre SPD has not identified this site as a preferred option for development as it has been demonstrated that although the Town Centre has a large surplus of parking spaces and that this needs to be rearranged, this site would likely form a key part in this rearrangement. The SPD background paper provides further information in this regard. Prior to the release or retention of any car park the Council require a car parking strategy to be produced to confirm that each site, in combination, are the most appropriate for release.</p> <p>For the purposes of the SHLAA, while this site may be suitable for development they are not considered available or achievable as they are required to meet the ongoing parking requirement for the Town Centre and residents. Preferred approach involves the retention of the area as car parking to accommodate parking which is proposed to be lost elsewhere in the town centre.</p>
Concluding actions	No further action.